



USER MANUAL

PROPRIETARY AND CONFIDENTIAL

THE INFORMATION CONTAINED IN THIS DRAWING IS THE SOLE PROPERTY OF SN SYSTEMS. ANY REPRODUCTION IN PART OR AS A WHOLE WITHOUT THE WRITTEN PERMISSION OF SN SYSTEMS IS PROHIBITED.

1. Mount foot and pole.

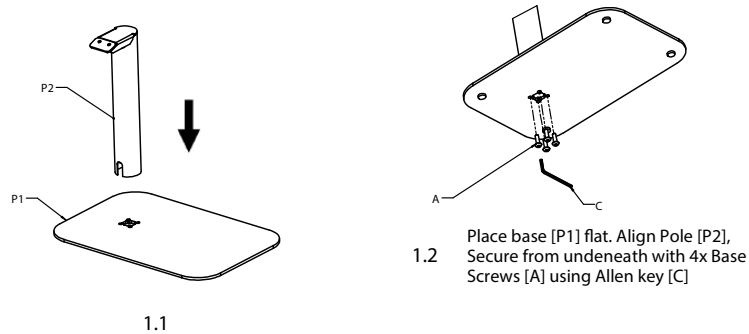

2. Mount head

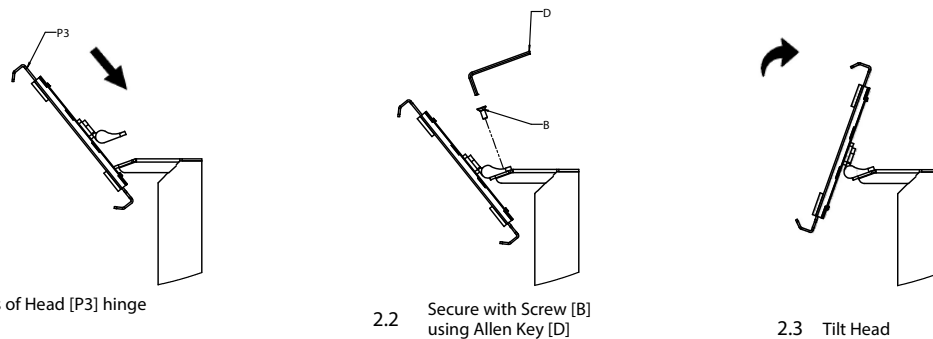

3. Insert power cable

2.1 Align Holes of Head [P3] hinge

2.2 Secure with Screw [B] using Allen Key [D]

2.3 Tilt Head

3. Insert power cable

4. Insert Tab

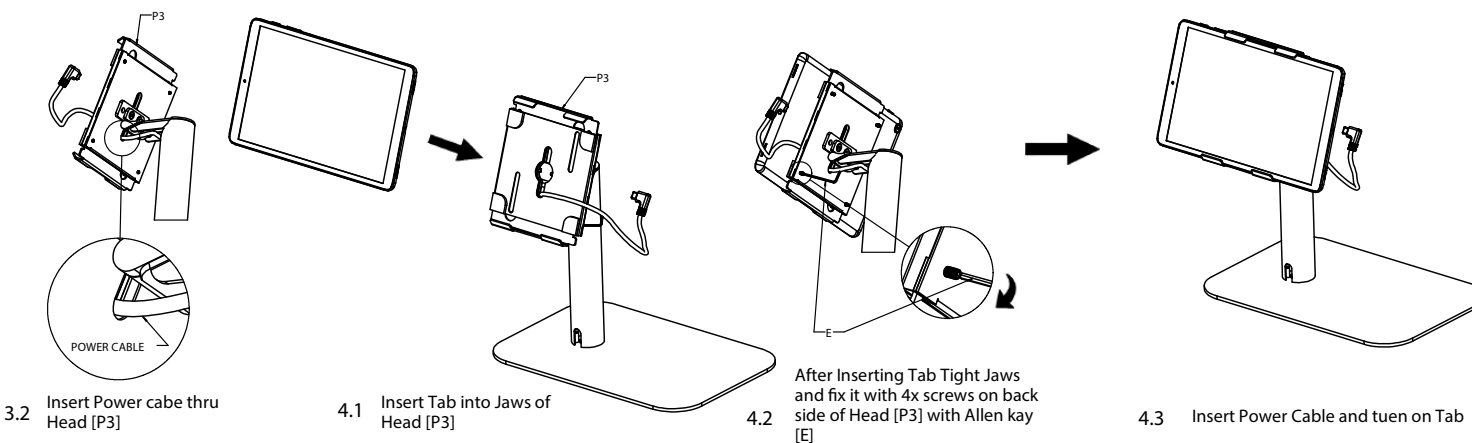

[P1]

Base



[P2]

Pole

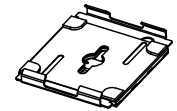

[P3]

Head



[A]

Screw M5x16
(x4)



[B]

Screw M4x10
(x2)

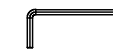

[C]

Allen key 3mm
(x1)



[D]

Allen key 2.5mm
(x1)



[E]

Allen key
(x1)